

DETECTION CONNECTION DETAILS			
SENSOR NO.	POLE NO.	DETECTION LOCATION	NOTES
MATRIX 1	2	SB LANE	
MATRIX 2	7	NB/NBL LANE	

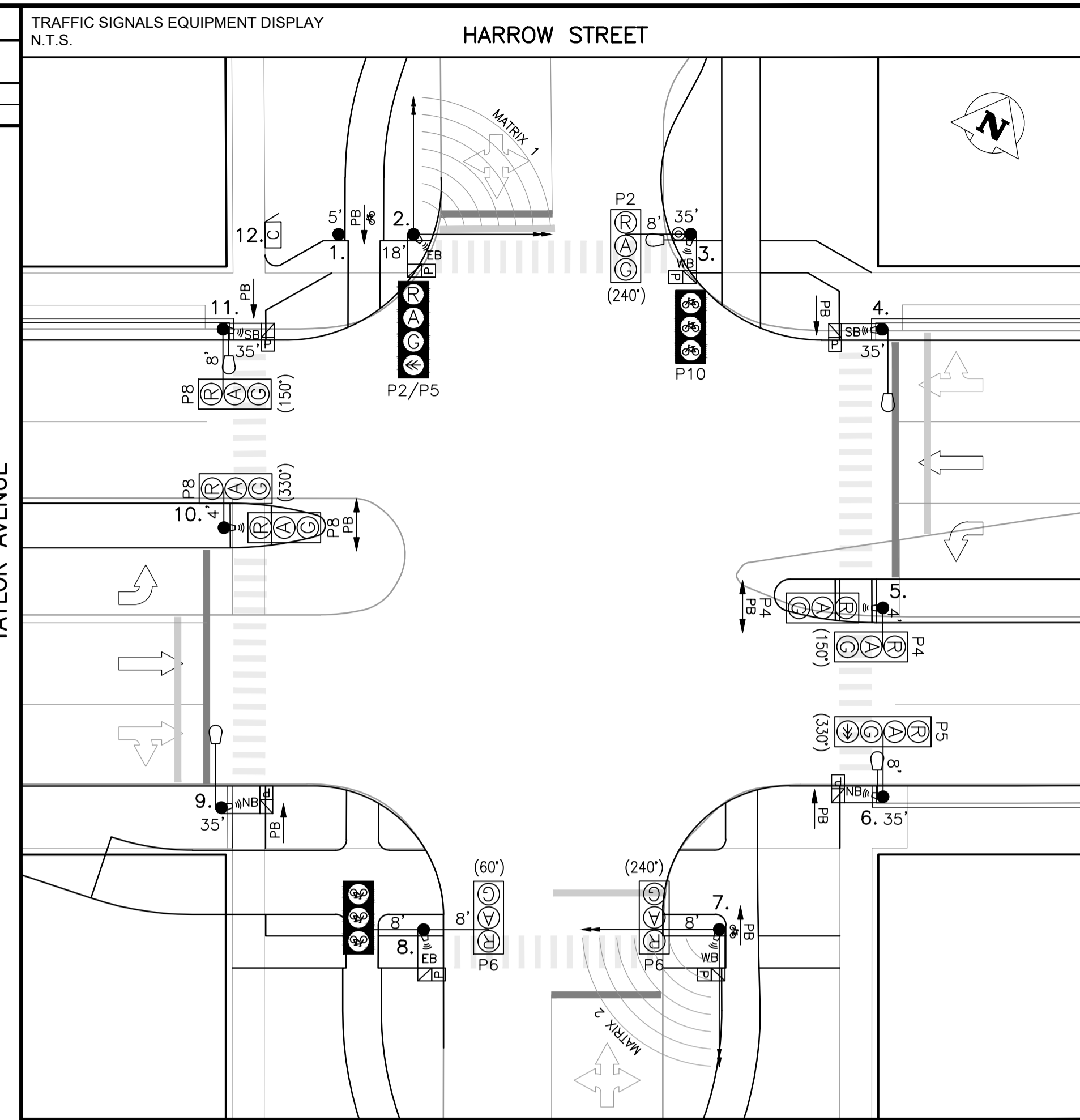

CONSTRUCTION NOTES:

- PROJECT SCOPE**
1. INSTALL CONDUIT, BASES AND PITS AS SHOWN. TOTAL LENGTH OF SERVICE CABLE: 75m.
 2. INSTALL GROUND ROD. INSTALL MAST & DISCONNECT ON ___ QUADRANT. INSTALL WEATHER HEAD 6" LOWER THAN LOWEST WIRE ON HYDRO POLE.
 3. INSTALL EQUIPMENT AS SHOWN.
 4. TIMINGS REQUIRED.

- PROJECT COORDINATION**
1. COORDINATE WORK WITH SCOTT SUDERMAN, (204) 489-5900, scott.suderman@stantec.com.
 2. TWO DAYS PRIOR TO CONSTRUCTION, COORDINATE REMOVAL OF SIGNALS EQUIPMENT FROM JOINT USE POLE #E3, #E8, & #E10 WITH DARREN TABAK, (204) 360-7521.
 3. COORDINATE HYDRO SERVICE INSTALLATION WITH (HYDRO DESIGNER), (204) XXX-XXXX. RE: JUTA PERMIT No. BXXXXX

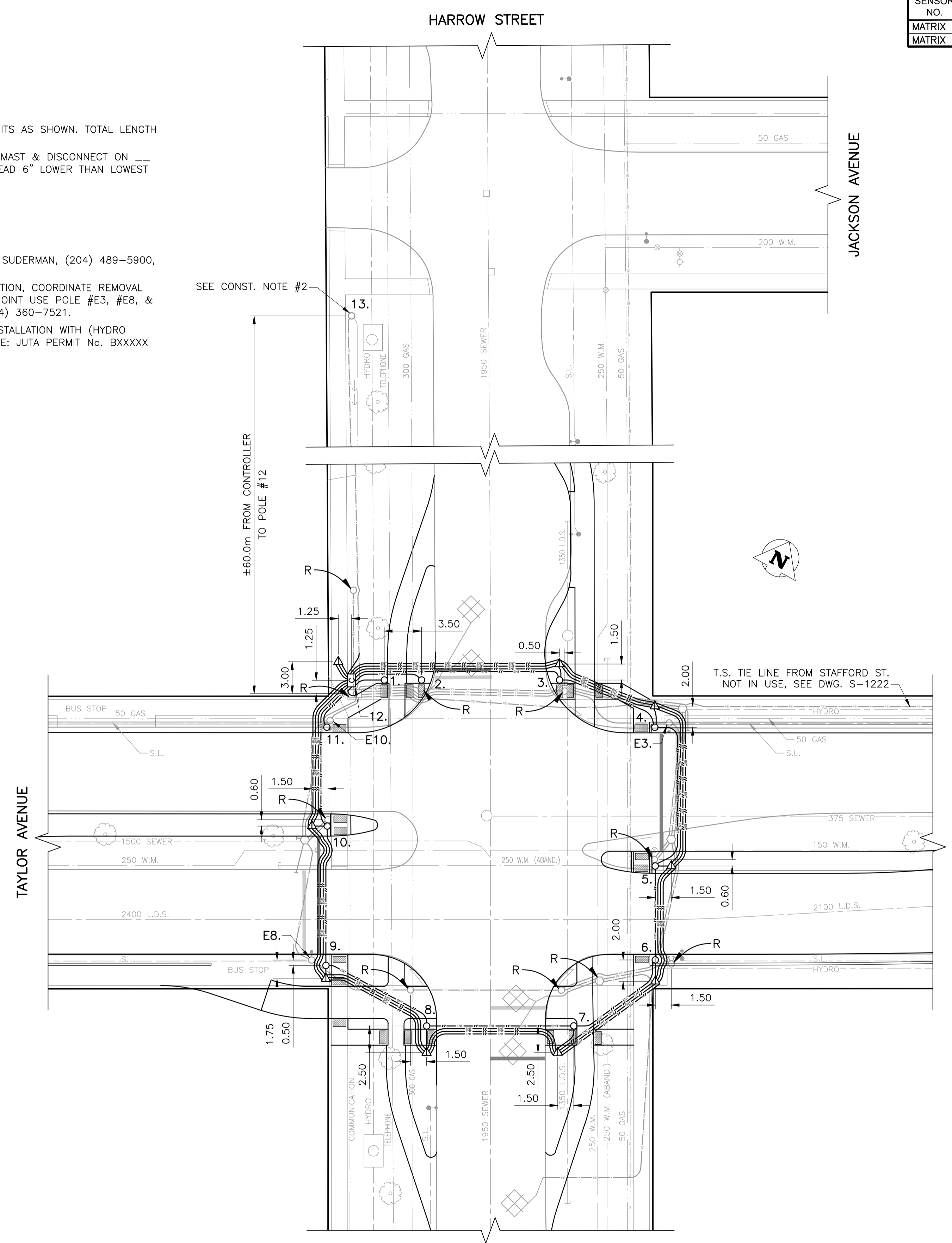

PLAN VIEW: UNDERGROUND CONSTRUCTION
1:250

EQUIPMENT DISPLAY LEGEND

EXISTING	PROPOSED (AS SHOWN BELOW)	DESCRIPTION
[Symbol]	[Symbol]	PEDESTRIAN HEAD
[Symbol]	[Symbol]	PEDESTRIAN HEAD WITH PCS
[Symbol]	[Symbol]	PEDESTRIAN CORRIDOR BOX
[Symbol]	[Symbol]	VEHICLE DETECTION AREA
[Symbol]	[Symbol]	PUSH BUTTON & DIRECTION
[Symbol]	[Symbol]	APS SINGLE DIRECTION
[Symbol]	[Symbol]	APS DUAL DIRECTION (2 SEPARATE SPEAKERS)
[Symbol]	[Symbol]	TRAFFIC SIGNAL HEAD
[Symbol]	[Symbol]	TRAFFIC SIGNAL POLE
[Symbol]	[Symbol]	RED FLASHER
[Symbol]	[Symbol]	AMBER FLASHER (CIRCUIT 'A' OR 'B')
[Symbol]	[Symbol]	LUMINAIRE
[Symbol]	[Symbol]	CAMERA

NO.	EQUIPMENT LIST	ARM	BASE	B.B.	NO.	EQUIPMENT LIST	ARM	BASE	B.B.
1.	5' SIGNAL		PM	M	11.	35' SIGNAL FOR 150 WATT LUMINAIRE	8'	OD	DD
2.	18' SIGNAL		A	A	12.	332 CABINET/2070 CONTROLLER			
3.	35' SIGNAL FOR 150 WATT LUMINAIRE	8'	OD	DD	13.	HYDRO WOOD AND CAMERA SERVICE:			
4.	35' SIGNAL FOR 150 WATT LUMINAIRE		OD	DD	E3.	35' SIGNAL		A	A
5.	CANTILEVER	4'	OD	DC	E8.	35' SIGNAL		A	A
6.	35' SIGNAL FOR 150 WATT LUMINAIRE	8'	OD	DD	E10.	35' SIGNAL	8'	G	G
7.	CANTILEVER	8'	OD	DC					
8.	DOUBLE CANTILEVER	8'/8'	OD	DC					
9.	35' SIGNAL FOR 90 WATT LUMINAIRE		OD	DD					
10.	CANTILEVER	4'	OD	DC					

TRAFFIC SIGNALS UNDERGROUND LEGEND

EXISTING	PROPOSED (AS SHOWN BELOW)	DESCRIPTION
[Symbol]	[Symbol]	1 1/2" PE CONDUIT
[Symbol]	[Symbol]	2" PE CONDUIT
[Symbol]	[Symbol]	2" ENT CONDUIT
[Symbol]	[Symbol]	AERIAL / BURIED CABLE
[Symbol]	[Symbol]	CONDUIT STUB
[Symbol]	[Symbol]	BREAK-IN
[Symbol]	[Symbol]	SPICE
[Symbol]	[Symbol]	SAW-CUT LOOPS
[Symbol]	[Symbol]	PERFORMED LOOPS
[Symbol]	[Symbol]	POLE BASE
[Symbol]	[Symbol]	CONTROLLER BASE
[Symbol]	[Symbol]	PEDESTAL BASE
[Symbol]	[Symbol]	TERMINAL BASE
[Symbol]	[Symbol]	SERVICE BOX (PIT)
[Symbol]	[Symbol]	24" PRECAST PIT
[Symbol]	[Symbol]	30" PRECAST PIT
[Symbol]	[Symbol]	36" PRECAST PIT
[Symbol]	[Symbol]	REMOVAL

SIGNAL BASE BOLT SQUARE TYPES

BOLT SQUARE (B.S.)	DIA.	DESCRIPTION
[Symbol]	8 1/8"	TYPE "A" - 8 1/8"
[Symbol]	6 3/4"	TYPE "B" - 6 3/4"
[Symbol]	8 1/8"	TYPE "C" - 8 1/8" SCREW TYPE
[Symbol]	12 3/4"	TYPE "D" - 12 3/4", 1 1/4" DIA. BOLTS, 24" DIA.
[Symbol]	12 3/4"	TYPE "OD" - 12 3/4", 1 1/4" DIA. BOLTS, 28" DIA.
[Symbol]	12 3/4"	TYPE "PD" - 12 3/4", PRECAST, 1 1/4" DIA. BOLTS
[Symbol]	9 9/16"	TYPE "E" - 9 9/16" SCREW TYPE
[Symbol]	9 9/16"	TYPE "F" - 9 9/16"
[Symbol]	8 1/8"	TYPE "G" - 8 1/8", 1 1/4" DIA. BOLTS, 89mm PROJ.
[Symbol]	8 1/8"	TYPE "GS" - 8 1/8", 1 1/4" DIA. BOLTS, 76mm PROJ.
[Symbol]	8 1/8"	TYPE "PG" - 8 1/8", PRECAST, 1 1/4" DIA. BOLTS
[Symbol]	9 7/8"	TYPE "H" - 9 7/8" SCREW TYPE
[Symbol]	7 3/4"	TYPE "I" - 7 3/4"
[Symbol]	10 5/8"	TYPE "J" - 10 5/8", 1 1/4" DIA. BOLTS
[Symbol]	10 5/8"	TYPE "K" - 10 5/8", PRECAST, 1 1/4" DIA. BOLTS
[Symbol]	6", 5/8"	TYPE "L" - 6", 5/8" DIA. BOLTS
[Symbol]	8 1/8"	TYPE "PM" - 8 1/8", PRECAST, 5/8" DIA. BOLTS

EXISTING	LEGEND	PROPOSED	EXISTING	LEGEND	PROPOSED	EXISTING	LEGEND	PROPOSED
[Symbol]	150 W.M.	[Symbol]	[Symbol]	PROPERTY LINE	[Symbol]	[Symbol]	TELEPHONE	[Symbol]
[Symbol]	HYDRANT	[Symbol]	[Symbol]	ROADWAY	[Symbol]	[Symbol]	TELEPHONE	[Symbol]
[Symbol]	VALVE	[Symbol]	[Symbol]	SIDEWALK	[Symbol]	[Symbol]	TELEPHONE	[Symbol]
[Symbol]	300 SEWER	[Symbol]	[Symbol]	CURB & CURB RAMP	[Symbol]	[Symbol]	TELEPHONE	[Symbol]
[Symbol]	MANHOLE	[Symbol]	[Symbol]	WARNING TILE	[Symbol]	[Symbol]	TELEPHONE	[Symbol]
[Symbol]	CATCH BASIN	[Symbol]	[Symbol]	SLOPE	[Symbol]	[Symbol]	TELEPHONE	[Symbol]
[Symbol]	CURB INLET	[Symbol]	[Symbol]	CULVERT	[Symbol]	[Symbol]	TELEPHONE	[Symbol]
[Symbol]	HYDRO	[Symbol]	[Symbol]	BUILDING	[Symbol]	[Symbol]	TELEPHONE	[Symbol]
[Symbol]	100 GAS	[Symbol]	[Symbol]	TREE	[Symbol]	[Symbol]	TELEPHONE	[Symbol]

UNDERGROUND STRUCTURES

UNDERGROUND STRUCTURES ID	DATE (YYYY/MM/DD)

WATER & WASTE REVIEW ID

NOTE: LOCATIONS OF UNDERGROUND STRUCTURES AS SHOWN ARE BASED ON THE BEST INFORMATION AVAILABLE. BUT NO GUARANTEE IS GIVEN THAT ALL EXISTING UTILITIES ARE SHOWN OR THAT THE GIVEN LOCATIONS ARE EXACT. CONFIRMATION OF EXISTENCE AND EXACT LOCATION OF ALL SERVICES MUST BE OBTAINED FROM THE INDIVIDUAL UTILITIES BEFORE PROCEEDING WITH CONSTRUCTION.

CONSTRUCTION REVISIONS

NO.	REVISION	DATE (YYYY/MM/DD)	BY
0	ISSUED FOR UGS APPROVAL	2020/01/25	J.S.

ACCOUNTS:

PENDING

DESIGNED BY: J.S.

DRAWN BY: J.S.

CHECKED BY: C.H.

APPROVED BY: [Signature]

LIABILITY DISCLAIMER NOTICE:
THE DIGITAL INFORMATION PROVIDED FOR YOUR CONVENIENCE HEREIN IS FOR USE AT YOUR OWN RISK. THE CITY OF WINNIPEG, PUBLIC WORKS DEPARTMENT, SHALL ASSUME NO RESPONSIBILITY FOR THE INFORMATION AND IT SHOULD NOT BE CONSTRUED AS ASSULT INFORMATION. THE INFORMATION SHOULD BE USED FOR PLANNING PURPOSES ONLY AND SHOULD BE VERIFIED BY SURVEY. THE DEPARTMENT SHALL NOT IN ANY WAY SUFFER ANY LIABILITY WHATSOEVER TO ANY PARTY FOR INJURY, LOSS OR DAMAGES SUFFERED BY SUCH PARTY ARISING FROM THEIR USE OF, OR RELIANCE UPON, THIS INFORMATION.

ENGINEER'S SEAL

PRELIMINARY

NOT FOR CONSTRUCTION

THE CITY OF WINNIPEG

Winnipeg

PUBLIC WORKS DEPARTMENT

TRANSPORTATION DIVISION

TRAFFIC SIGNALS

HARROW ST. & TAYLOR AVE.

UNITS: ALL DIMENSIONS ARE IN METERS UNLESS OTHERWISE NOTED

DRAWING NUMBER: S-1661